







WiFi Smart Motorized Socket

User Guide



-  WiFi connection
-  One App control your home
-  Night lamp
-  Bluetooth speaker
-  Control your device anywhere
-  Device Sharing

Model No: SNS-

Input: AC110-250V

APP: Smart Life

Output: 10A-16A

WiFi: 2.4G_WiFi

I、 Functional description

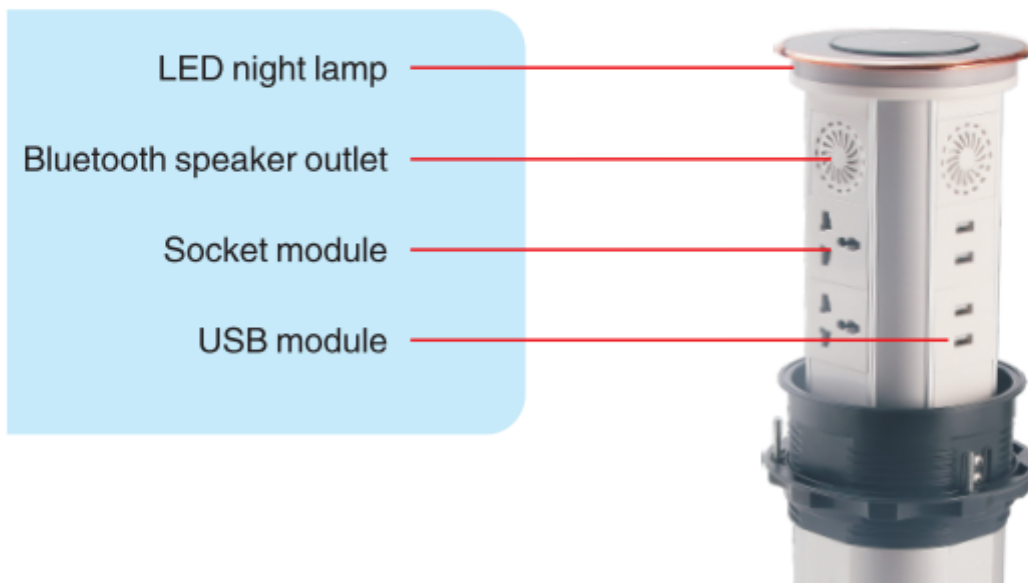
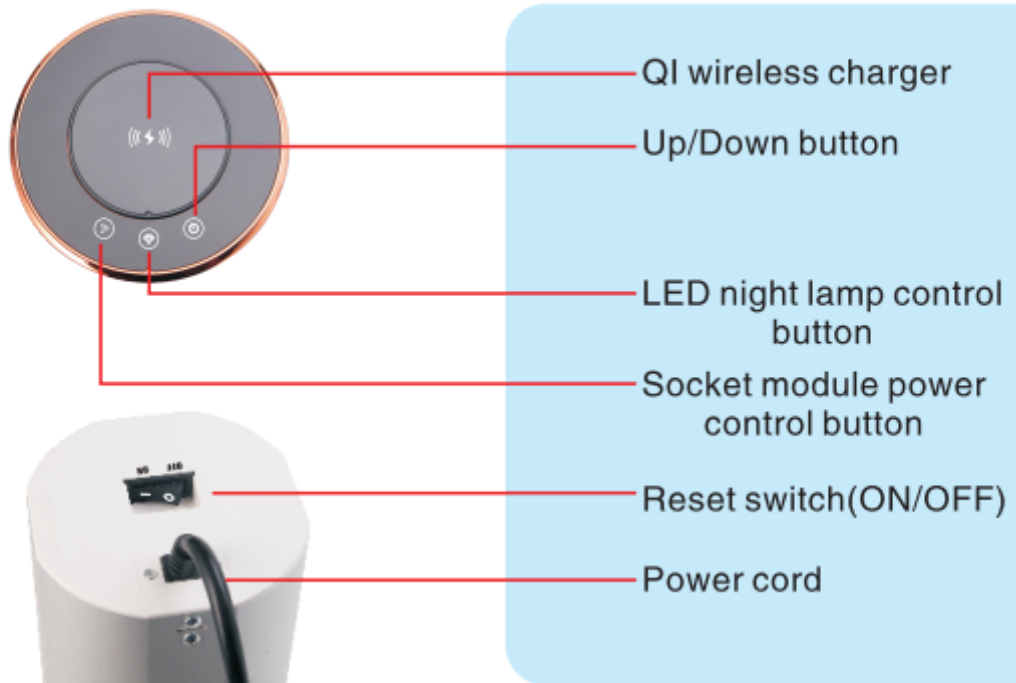

II、 Touch button instructions

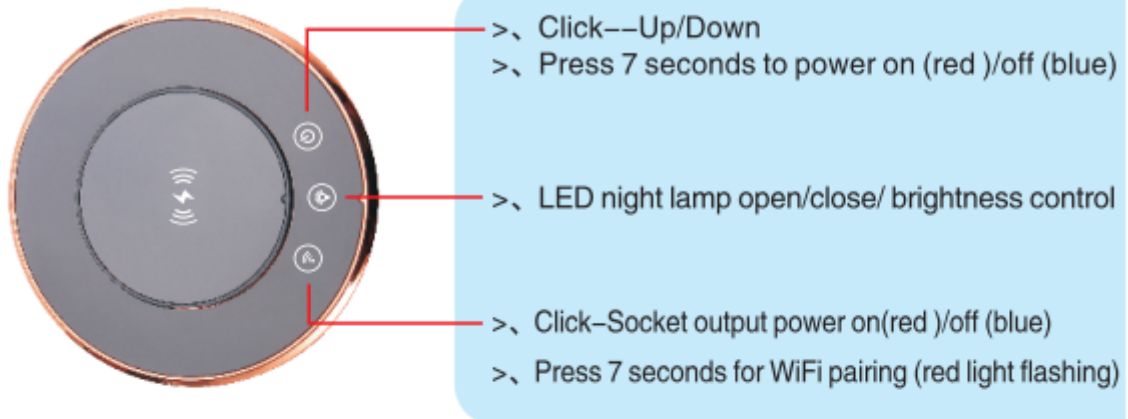

III、 Network pairing process

Preparation before use

- >、 Make sure the reset switch at the bottom is in the 'ON' state
- >、 Your Smart phone or tablets has connected to a 2.4G WiFi with internet
- >、 Not allow to hide WiFi(SSID).
- >、 Do not set "not allow Wi-Fi squatter" or MAC address limits on routers

1、 Download APP



Smart Life 

In APP store or Google search 'Smart Life'

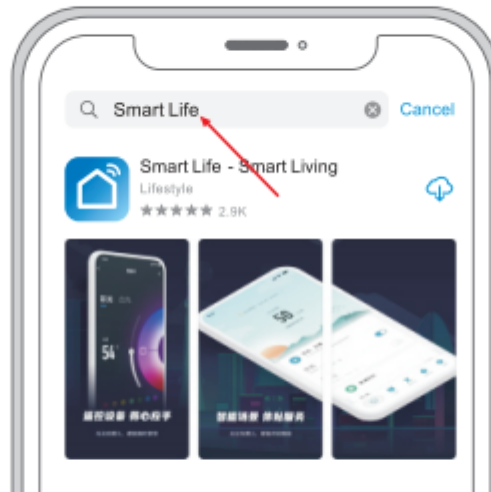

2、 If permission request appears in APP, please allow it

3、 Register an account and log in

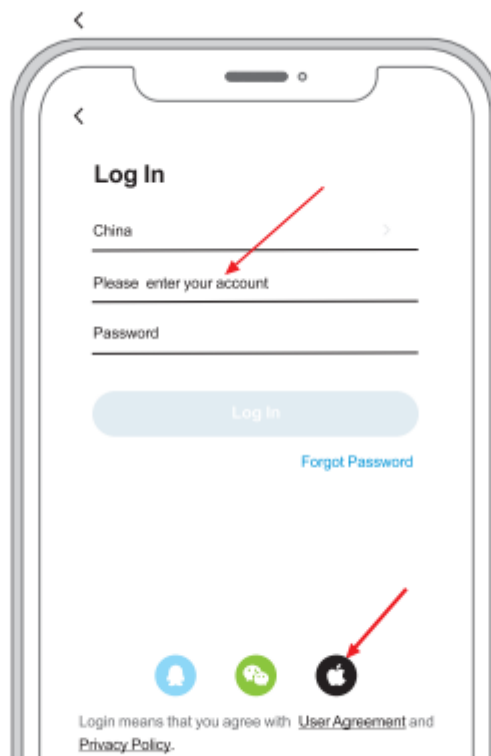

- 4、 **Connected power supply and turn on the bottom reset switch to “ON” position.**



- 5、 **Observe the LED:** If the red LED fast blinks (twice a second), is in pairing mode, direct next step. If the red LED is not in fast blinks (twice a second), press the button for 7s until the red LED fast blinks (twice a second).



6、 Tap ‘+’ or ‘Add Device’ to add a new device

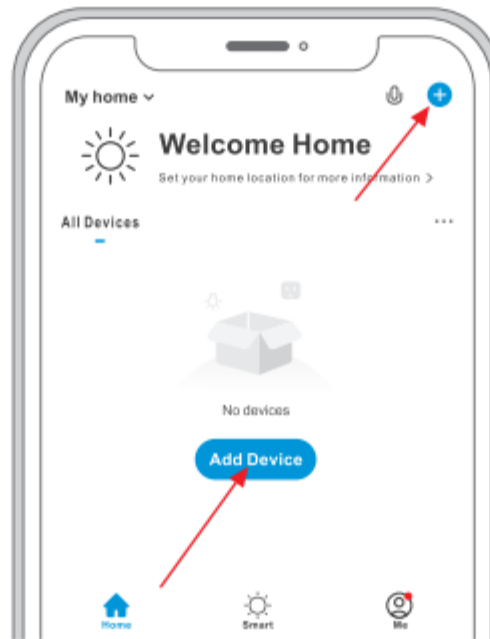

7、 Select ‘Others’ ①-> ‘Others(Wi-Fi)’ ②



8、 Input your home WiFi password, click ‘Next’



9、 Select ‘Confirm the indicator is blinking rapidly’ , click ‘Next’

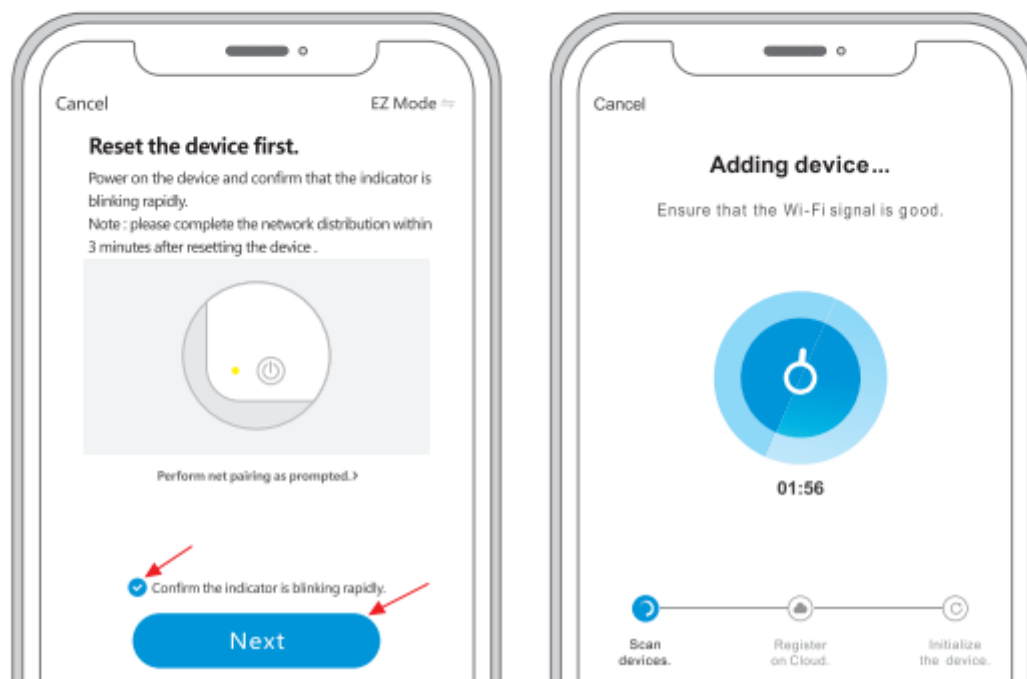

10、 Complete and can rename new device

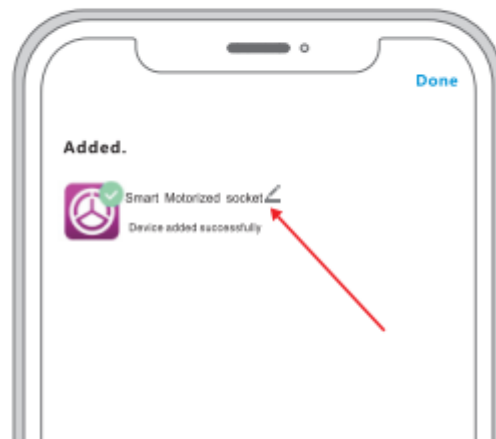

11、 The control interface appears after successful configuration



FAQ: Pairing failed, timeout

- 1、 Check WiFi password, try again
- 2、 Restart Router, try again
- 3、 Try Compatible Pairing Mode
- 4、 Read Help Center or Fill in the feedback

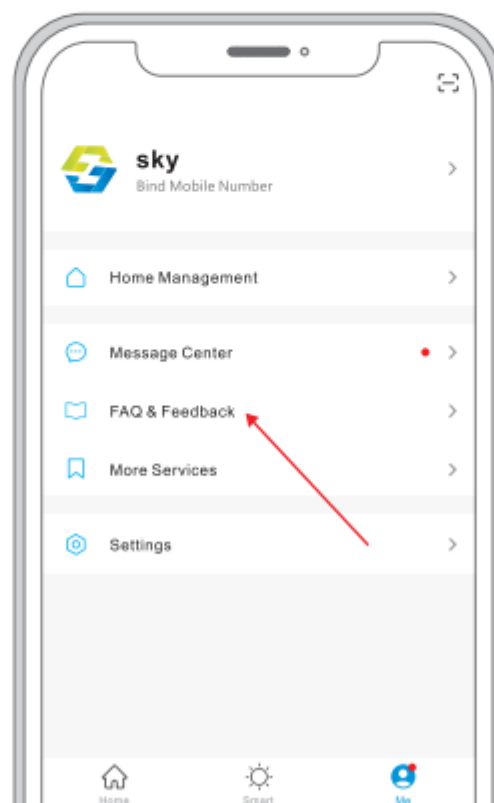

Why the device offline after successful connected?

If this happened, please check it according to following methods:

1. Whether the equipment power connected or not?

2. Whether the equipment has a power cut or internet cut?

If happened, need 2–3 minutes to reconnected.

3. Whether the network, where the equipment located stable?

Checking way: Put your mobile or iPad at the same network, then try to open the web page.

4. Whether the home Wi-Fi network is working or not?

If modified Wi-Fi name or password, ect, need to reset the device to re-add.

5. If the network is working, thus the device still offline, please check whether there are too many Wi-Fi connected? You can try to restart the router, reset the device power. Then wait for 2–3 minutes to see this device can be online or not?

If all above ways tried and still problem exist, suggest to remove the device, then re-add. If there is still problem, please select the device in APP filled the user feedback and submitted. Our engineer will check it.

VII、 Technical parameters

Input Voltage: 110V–250V~, 50Hz–60Hz

Rated output: 10A□ 13A□ 15A□ 16A□

USB output: DC5V/2.1A

Wireless charging: QI/15W

IP rating: IP55

Flame retardant rating: UL/V0

Ambient temperature: -20°C ~ +50°C

Open hole dia.: \varnothing 125mm

Tabletop/countertop thickness: 8mm–60mm

Outline dimension: See figures as below

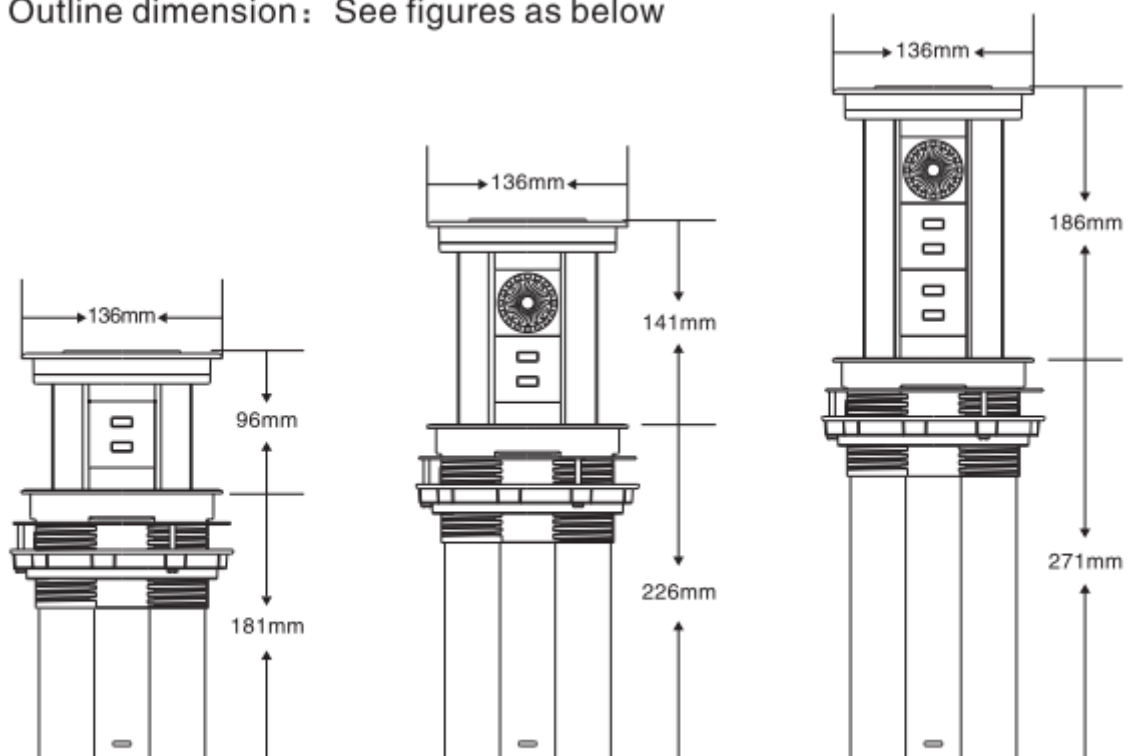

VIII、 Installation instruction

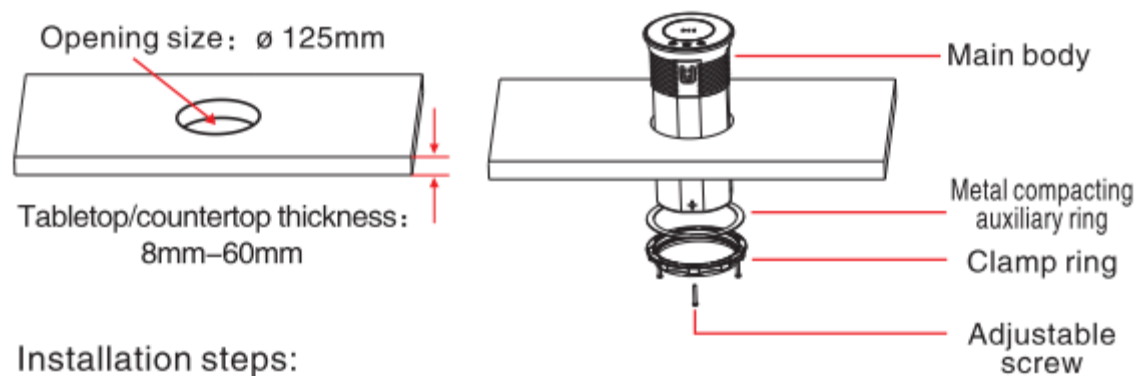

Installation steps:

- 1、 Open the hole according to requested size
- 2、 Put the main body in the hole from above
- 3、 Install the metal compacting auxiliary ring from below
- 4、 Install the clamp ring from below
- 5、 Adjust the length of the three screws on the clamp ring according to the actual installation requirements